

# CR 17

## PROPOSED IMPROVEMENTS CR 38 TO CR 142 PROJECT INFORMATION SHEET



### PROJECT PURPOSE

- Improve the mobility & safety of northbound and southbound traffic in western Elkhart County
- Improve substandard geometry to satisfy the requirements for a Principal Arterial Roadway
- Reduce congestion on nearby roadways, including high-traffic volumes on SR 19 and SR 15

### PROJECT MAP

Phase II, Segment 1a | Phase II, Segment 1b

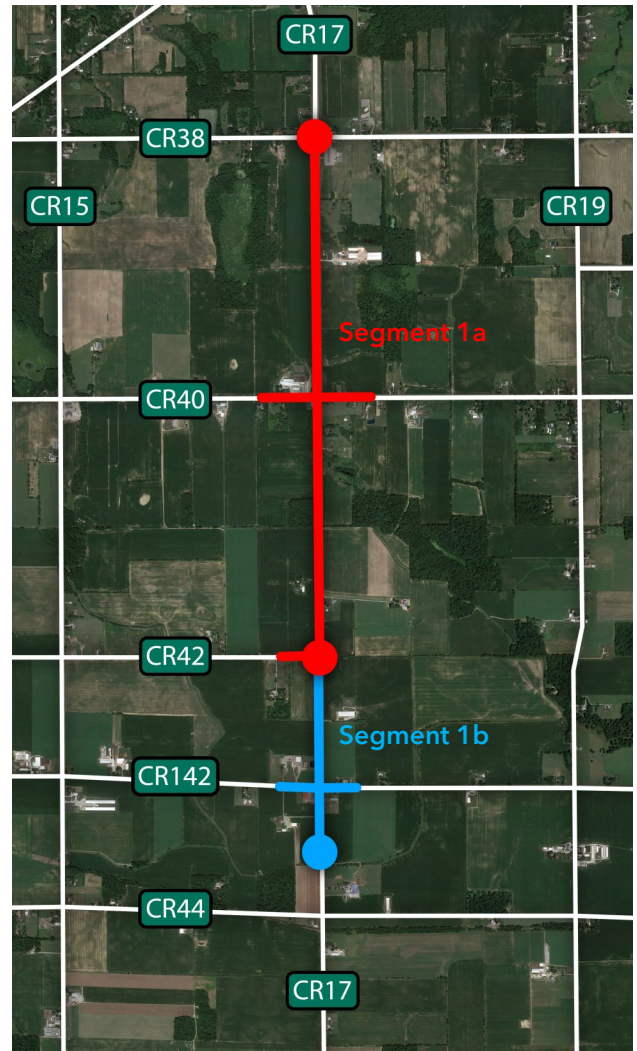

The CR 17 Improvement Project is a priority in the Michiana Area Council of Governments (MACOG) 2045 Long-Range Transportation Plan.

### PROPOSED 2-LANE IMPROVEMENTS

- Resurface CR 17 south of CR 38 to north of CR 40
- Widen CR 17 to 12-foot lanes with 10-foot paved shoulders from north of CR 40 to south of CR 142
- Generally follow existing alignment, centerline shifts may occur to minimize homestead impacts
- Maintain & reconstruct all driveways
- Upgrade drainage (culverts) & construct 4-foot to 10-foot roadside swales along east and west sides
- Tie drainage into existing streams and County-regulated drains
- Signalize and add turn-lanes at CR 40 & CR 142 Intersections

### PROPOSED CR 17 TYPICAL ROADWAY SECTION

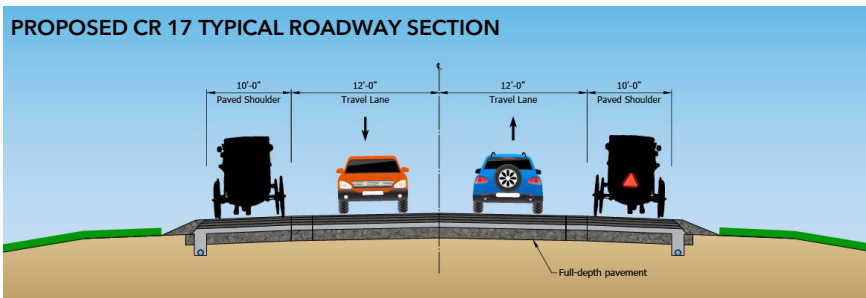

# PROPOSED INTERSECTION IMPROVEMENTS

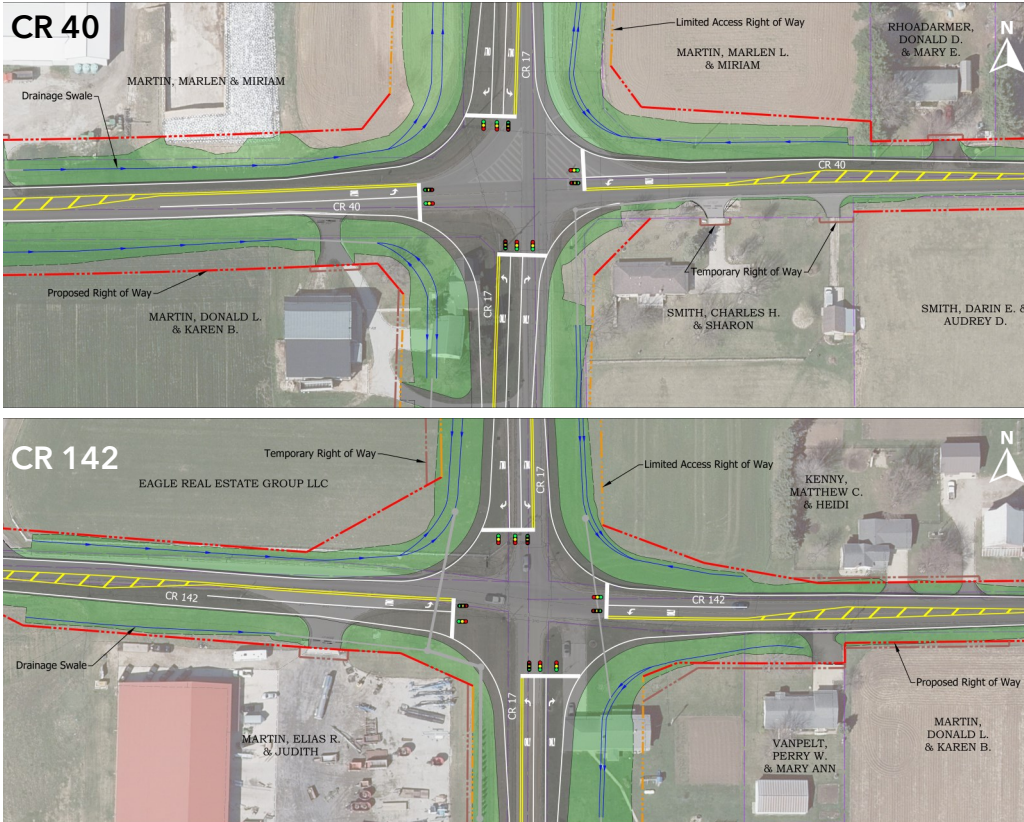

Have questions? Please contact:  
**C.J. CUNNINGHAM** at  
[ccunningham@lochgroup.com](mailto:ccunningham@lochgroup.com)

## PHASE II, SEGMENTS 1-4

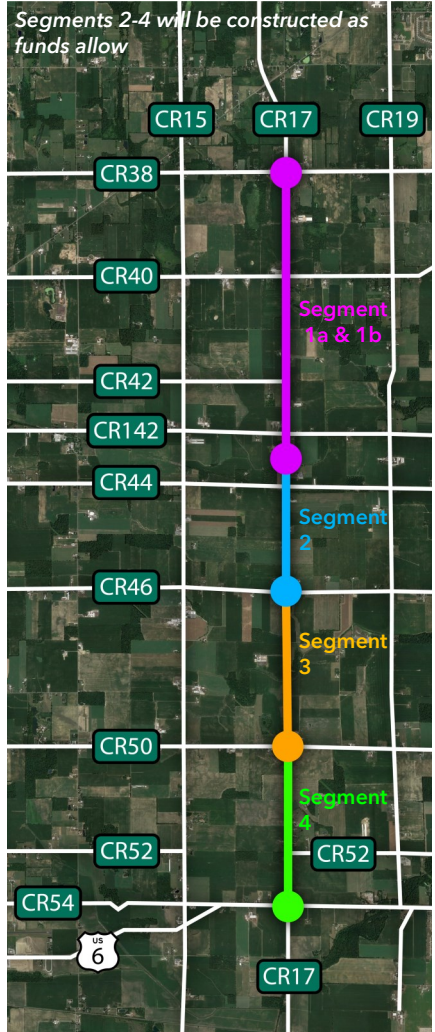

## PROJECT HISTORY

<b>2003</b>	Construction begins on CR 17 from Indiana State Line to US 20, including Toll Road Interchange Construction begins on CR 17 from US 20 to CR 28
<b>2004</b>	Environmental Assessment Approved on CR 17 from CR 28 to US 6 FONSI (Finding of No Significant Impact) for CR 17 from CR 28 to CR 38 received and project moved from design to construction
<b>2005</b>	Construction on CR 17 completed between US 20 and CR 28
<b>2012</b>	Construction Completed on CR 17 from CR 28 to CR 38
<b>2019</b>	Funding Awarded for Phase II, Section 1A & 1B

## TIMELINE

